

# Installation & RGB System Control Instructions

Warranty No: \_\_\_\_\_  
Please Keep this for warranty

## WALL MOUND P90/ P120 /P150 POOL LIGHTS MODEL OPERATING AND SAFETY INSTRUCTIONS

Congratulations, on your purchase of one of the most advanced LED leakproof sealed ceramic technology lights, in the world today. Your Next Generation Wall mount LED pool lights, will provide you with years of trouble free use and enjoyment. P90/P120/P150 are fully sealed leak-proof technology has been proven internationally for many years Your new P90/ P120 /P150 consumes less power, run cooler , requires no maintenance and you will never have to change a globe in your pools again.

Please take a few minutes to read and observe the following installation and safety information.

P90/ P120 are AC/DC 12V-24 , P150 is AC/DC 12V volts unless specifically stated.

### WARNING:

1. P90/ P120 /P150 are extremely bright, please DO NOT look directly at the light as it may damage your eyes.
2. P90/ P120/ P150 MUST only be switched on under the water
3. Accessories included as below:



Retrofit mounting bracket x 1



30mm Stainless steel screw x 4  
10mm Stainless steel screw x 1



Heat-Shrink Tube:  
Ø3mm x 2  
Ø9mm x 1  
Ø15mm x 1



P90 LED pool lights x 1 / P120 LED pool lights x1 / P150 LED pool lights x 1

### RISK OF ELECTRICAL SHOCK OR ELECTROCUTION

This underwater lights fixture must be installed by a certified electrician or a qualified pools serviceman in accordance with all applicable local codes and standards. Improper installation may create an electrical hazard which could result in death or serious injury to pool users, installers or others due to electrical shock and may also cause damage to property. Always disconnect power to the pool lights before servicing . DO NOT connect your new P90/ P120 / P150 to the incorrect voltage or you may damage your lights and void warranty. All Pool lights **MUST** turn on under the water only.

### INSTALLATION INSTRUCTIONS

A: Preparatory steps which must be completed by the electrician or pools builder before lights is installed see Figure 1:

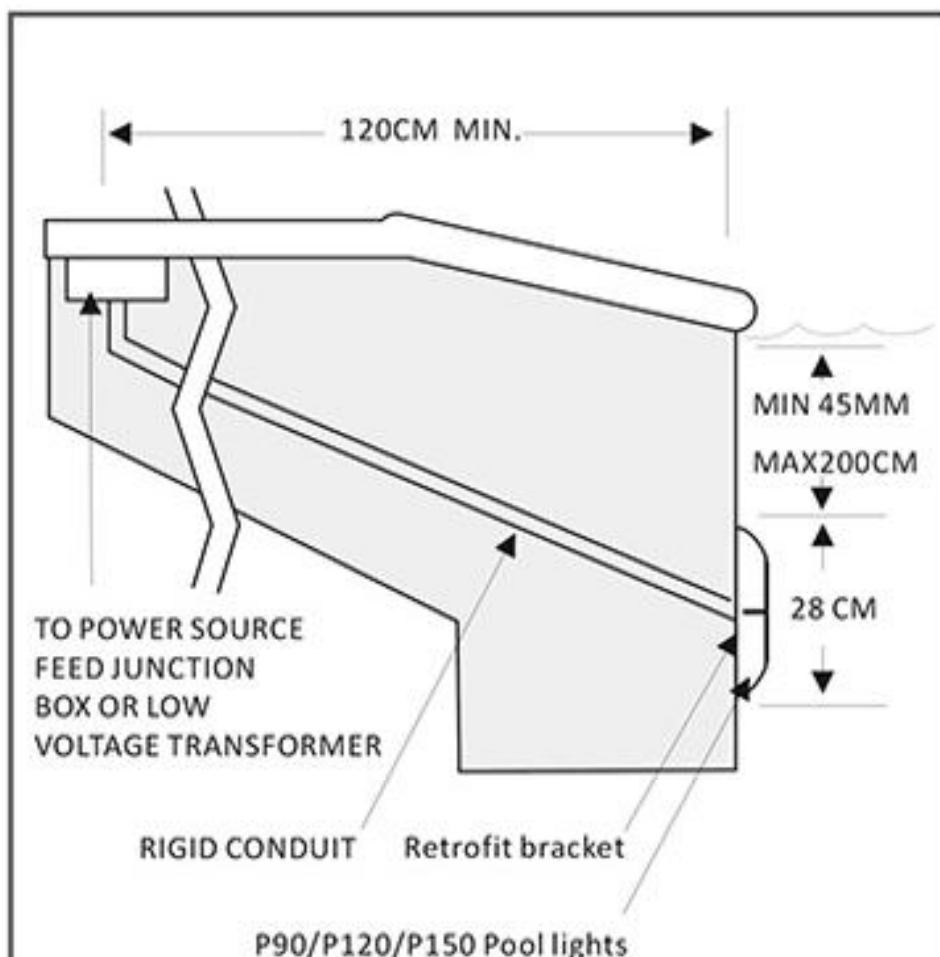

Figure 1

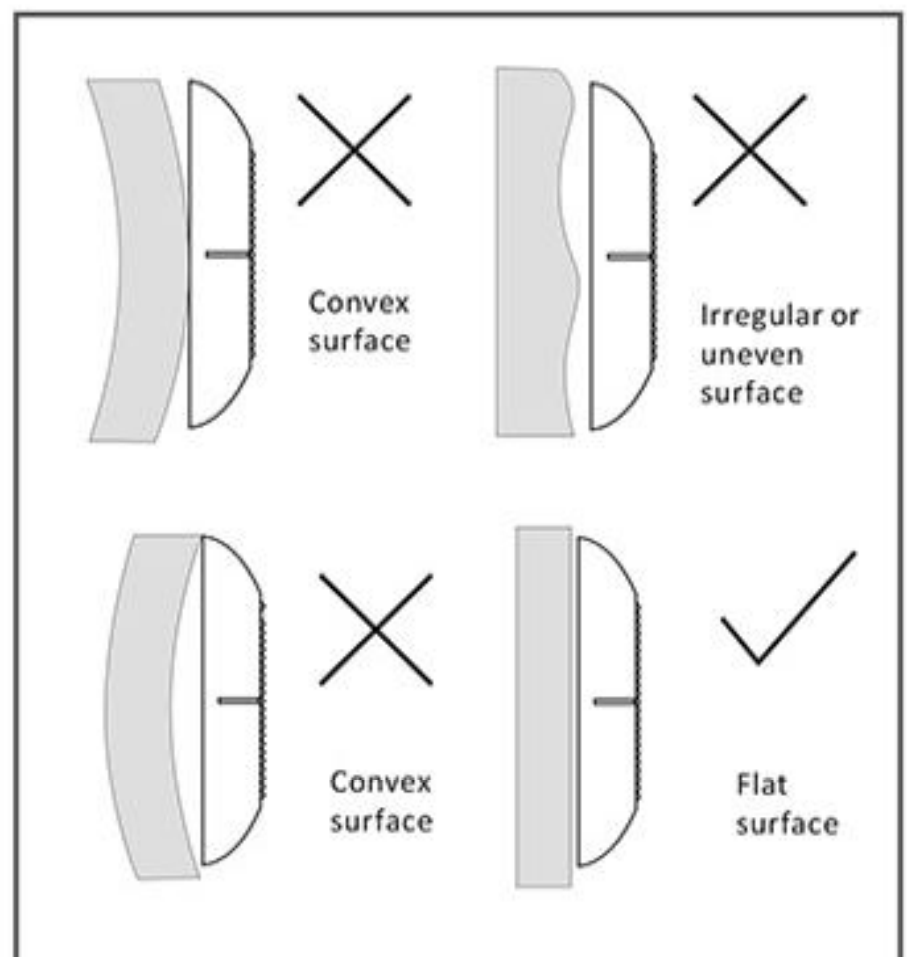

Figure 2

- A. Ensure that the electrical system of the pools conforms to the requirements of all the local codes and standards. A licensed certified electrician must install the electrical system to meet or exceed those requirements before the Underwater Lights is installed.

The mounting bracket must be properly installed so that the edge of the face plate of the underwater light's LEDs are at least 45 cm below the surface of the water in the pools, (Fig 1)

- B: Perform the following steps after the electrical system requirements are met.

1. Locate position on the vertical wall where lights are to be installed. The edge of the face plate must be 40~50 cm below normal water level, see Figure 1
2. Remove the existing pool lights and mounting bracket. Select the existing mounting holes, affix the Retrofit bracket to the pool wall ensuring that the "TOP" marking on the Retrofit bracket is facing up.
3. Mounting spacer MUST be flat with the face of mounting spacer, this ensures a snug fit between the light and wall (Fig 2)
4. Lower the light into the water and hide the cable behind the lights fitting. Insert the base of the light into the base of the Retrofit bracket and tilt the lights back into position. Insert the screw into the hole at the top of the light and secure( Fig 3)
5. Wrap a length of cord up to a maximum of 2 m long at the back of the light assembly. This extra cord allows you to bring the lights out of the pools for replacing LED and servicing.
6. Connect cord electrical wires at transformer , through conduit.
7. Connect all wires to the corresponding circuit wires in the junction box and feed to cable housing.
8. Never leave lights on for more than 8 hours at one day.

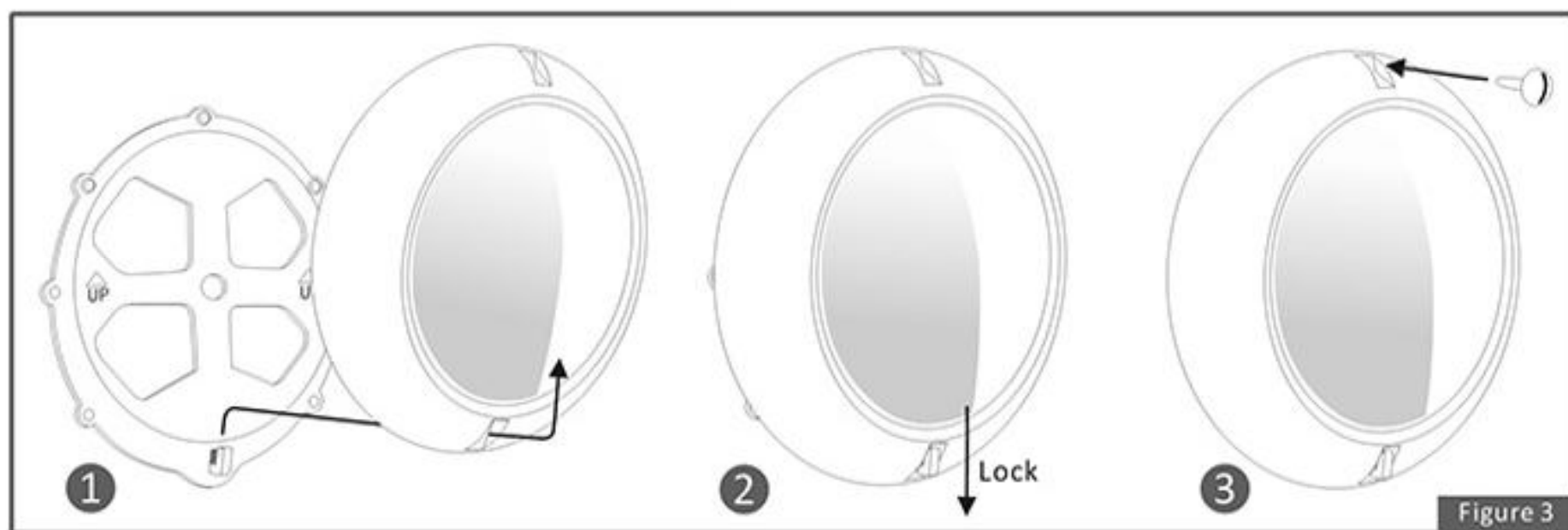

Figure 3

## RGB COLOUR CHANGING CONTROLLER SYSTEM

P90/P120 /P150 RGB Lights should be installed on the same transformer or multiple transformers on the same switch. To achieve the synchronization when installing multiple lights, Make sure each lights is installed correctly and on the same circuit. ( Fig 4). Switch the lights on for more than 10 seconds, the first colour changing program will start . Turn the lights switch off and wait for 1-2 seconds and turn back on. Program will change . \*\*If the pool lights are not at the same program. Please turn the lights off and wait 3-6second and turn the lights on . All pool lights program will back to program no 1 \*\*

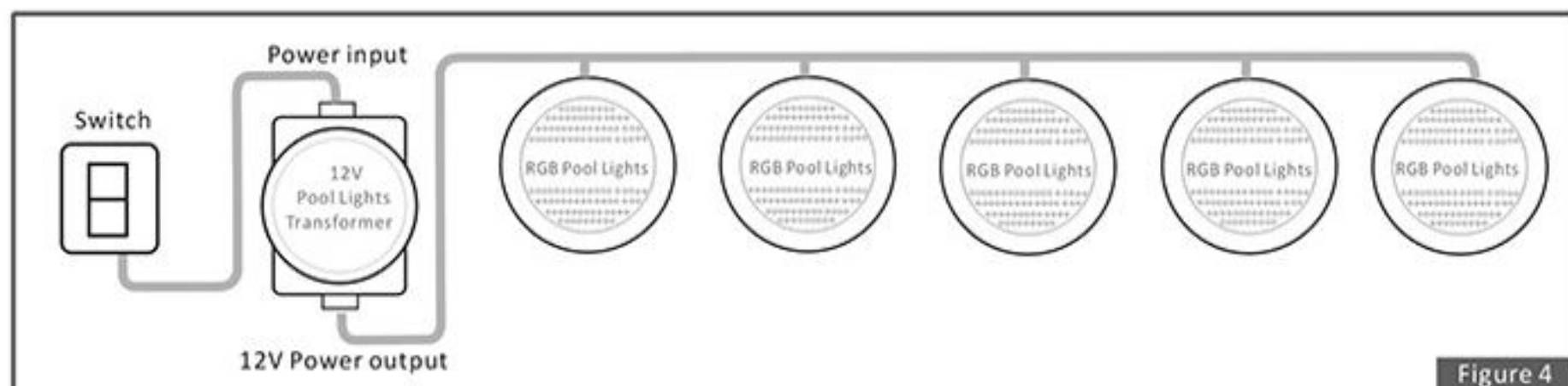

Figure 4

## RGB Programs

- |   |                                   |                                     |
|---|-----------------------------------|-------------------------------------|
| 1. Deep Blue Sea :Slow animation for Blue | 5. Ocean Blue : One colour Blue   | 8. Neutral white : One colour White |
| 2. Party :Fast animation for all colour   | 6. Glass land : Blue and Green    | 9. Pink Lady : Red/Blue             |
| 3. Sun Set :Slow animation for Red        | 7. Ocean Green : One colour Green | 10. Sunset : Red/Green/Blue         |
| 4. Sky blue : Green and Blue              |                                   | 11. Orange Road : Red/ Green        |